

INCUBATORS AH12 - AH24 - AH49

Nutrition & Protection



AFARION FASOLI
WWW.ARIONFASOLI.COM 

AH INCUBATOR - DETAILED VIEW

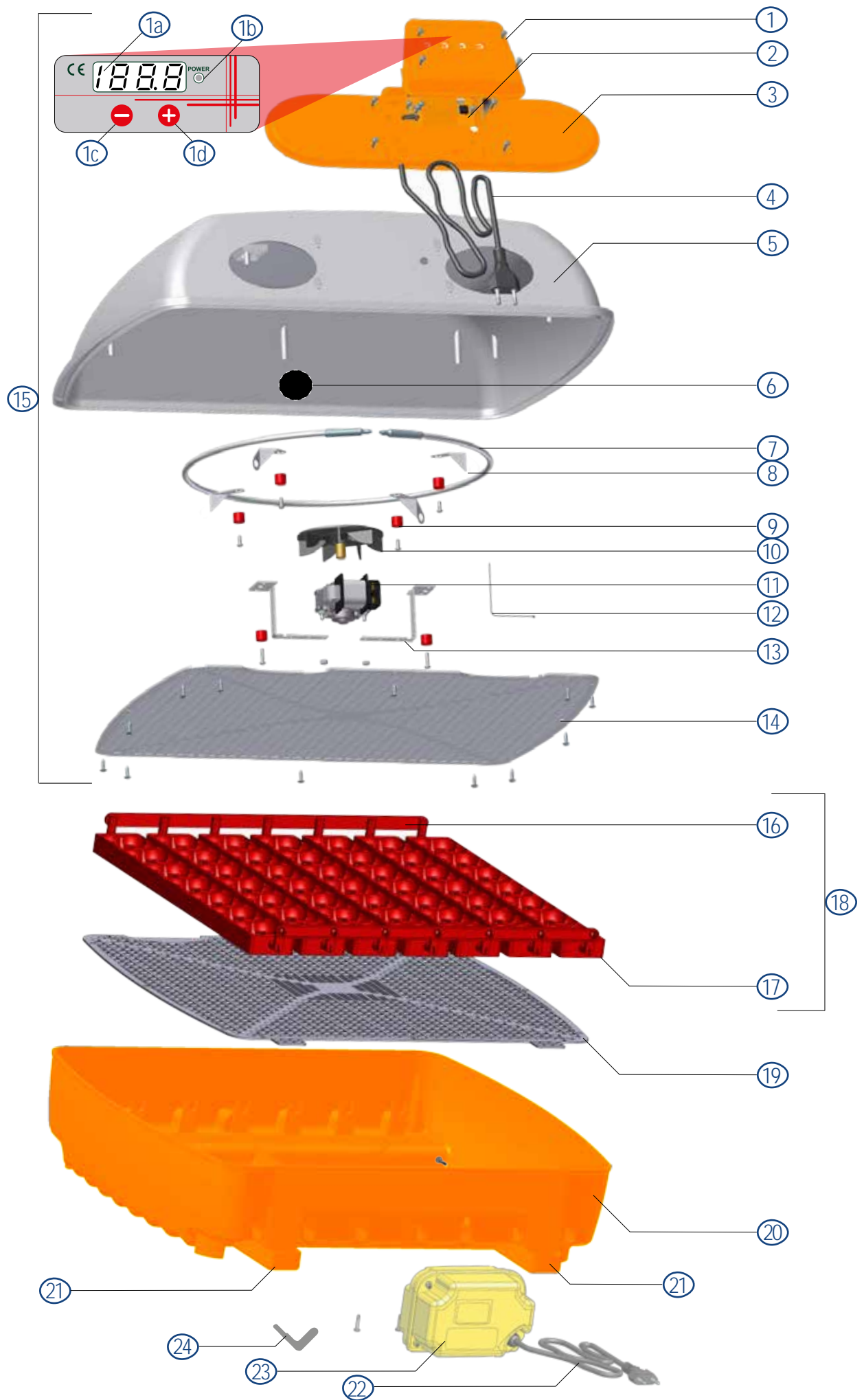

SPARE PARTS

Here you can find all the available spare parts for your AH incubator



Code number
AH 12: **512-03**
AH 24: **524-03**
AH 49: **549-03**

(2) (12)



Code number
AH 12-24-49: **25549850**

(6)



Code number
AH 12: **27512000**

(7)



Code number
AH 24: **22524000**

(7)

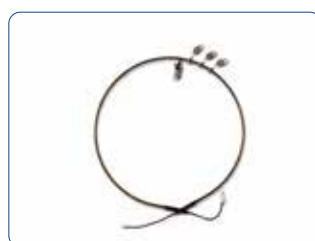

Code number
AH 49: **22549000**

(7)



Code number
AH 12: **512-05**
AH 24: **524-05**
AH 49: **549-05**

(10) (11) (13)



Code number
AH 12: **40512000**
AH 24: **40524000**
AH 49: **40549000**

(15)

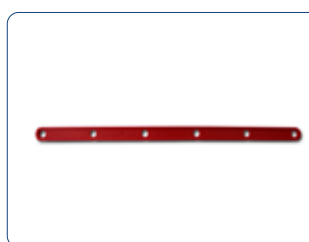

Code number
AH 12: **25512700**
AH 24: **25524700**
AH 49: **25549700**

(16)

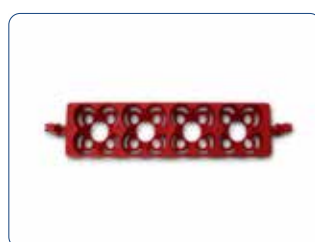

Code number
AH 12: **25512400**
AH 24: **25524400**
AH 49: **25549400**

(17)

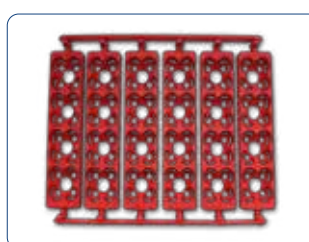

Code number
AH 12: **512-06**
AH 24: **524-06**
AH 49: **549-06**

(18)

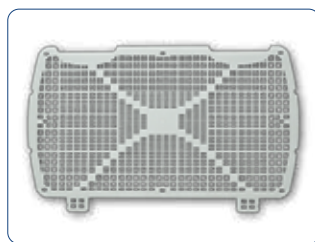

Code number
AH 12: **25512510**
AH 24: **25524510**
AH 49: **25549510**

(17)



Code number
AH 12: **25512120**
AH 24: **25524110**
AH 49: **25549110**

(20)



Code number
AH 12-24-49: **556M-1**

(23)



Code number
AH 12-24-49: **23800300**

(24)

THE EGGS

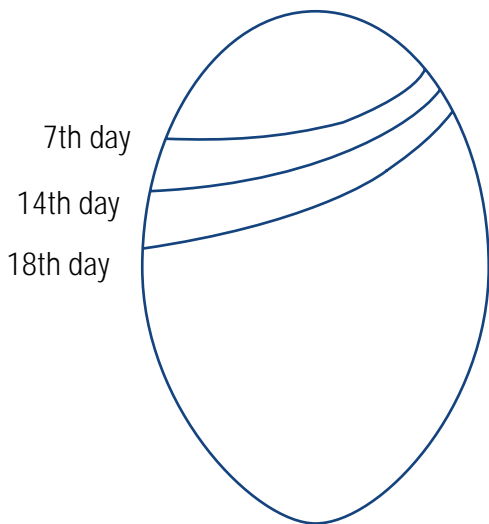

The air cell in an egg provides the chick with air when it is ready to start breathing on its own and hatch from the egg. As the chick starts breathing, there is a buildup of carbon dioxide in the egg, which prompts the chick to break through the egg to get fresh air.

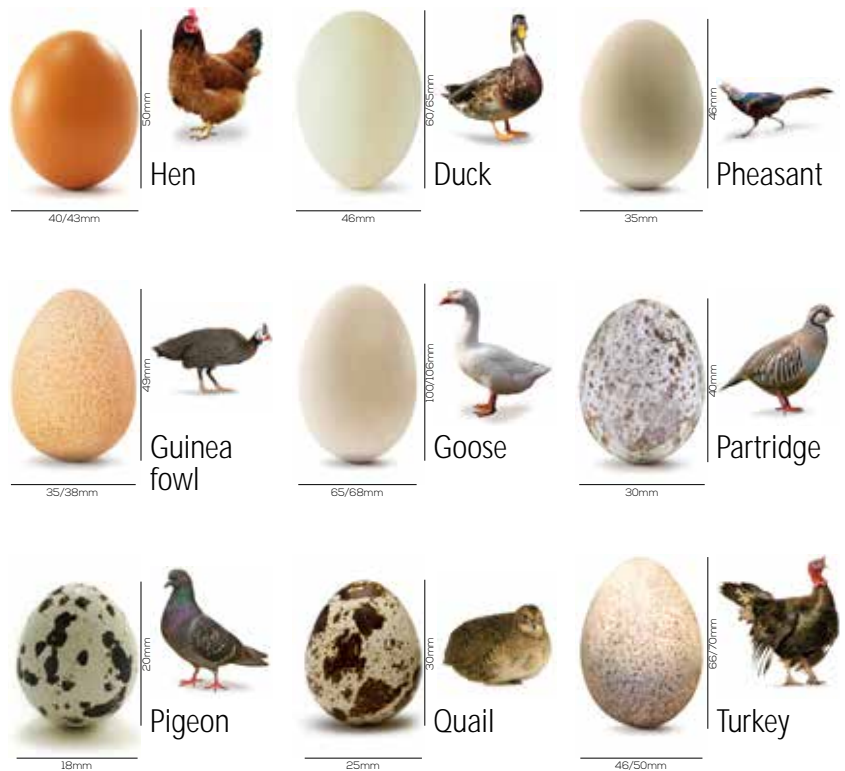

CHOOSING THE EGGS

Egg suitable for incubation



Eggs with low hatching rate



Eggs to be discarded

